

FOOTBALL GOAL POST FOUNDATION DETAIL

NOT TO SCALE

DIVISION 3 - CONCRETE

- THE LATEST REVISION OF THE FOLLOWING CODES GOVERN THE DESIGN, DETAILING, FABRICATION AND CONSTRUCTION OF ALL REINFORCED CONCRETE.
 - AMERICAN CONCRETE INSTITUTE (ACI) ACI 318, BUILDING CODE REQUIREMENTS FOR REINFORCED CONCRETE.
 - ACI 315, DETAILS AND DETAILING OF CONCRETE REINFORCEMENT.
- ALL EXTERIOR CONCRETE (INCLUDING FOUNDATION WALLS, PIERS AND FOOTINGS) SHALL BE AS FOLLOWS:
 - MINIMUM 28-DAY COMPRESSIVE STRENGTH (F'_c) = 4,500 PSI.
 - SLUMP = 3" TO 5".
 - WATER/CEMENTITIOUS RATIO = 0.45
 - AIR ENTRAINMENT = 6% +/- 1%.
 - EXPOSURE CLASSES = F3, S0, W1 AND C2.
- CONCRETE SHALL BE TESTED BY AN INDEPENDENT TESTING AGENCY. A SET OF (3) CONCRETE TEST CYLINDERS SHALL BE MADE AND TESTED FOR COMPRESSION STRENGTH A 7 AND 28 DAYS OR EVERY 50 CUBIC YARDS OF CONCRETE CAST (MINIMUM OF (1) SET PER DAY OF CASTING). ALSO, SLUMP AND UNIT WEIGHT TESTS SHALL BE PERFORMED EVERY OTHER TRUCK LOAD. CONTRACTOR MADE CONCRETE TEST CYLINDERS ARE NOT ACCEPTABLE.

UTILITY NOTE

THE UTILITY LOCATIONS AS HEREIN SHOWN ARE BASED ON FIELD OBSERVATIONS AND A CAREFUL REVIEW OF MUNICIPAL AND UTILITY RECORDS. HOWEVER, IT IS NOT POSSIBLE TO DETERMINE THE PRECISE SIZE, LOCATION, DEPTH, PRESSURE, OR ANY OTHER CHARACTERISTICS OF UNDERGROUND UTILITIES, TANKS OR SEPTIC FIELDS WITHOUT EXCAVATION. THEREFORE, WE CANNOT GUARANTEE THE ACCURACY OF COMPLETENESS OF THE BURIED UTILITY INFORMATION HEREIN SHOWN. THE CONTRACTOR SHALL CALL "MISS DIG" AT (811) A MINIMUM OF THREE WORKING DAYS PRIOR TO ANY EXCAVATION. IT SHALL BE THE RESPONSIBILITY OF THE CONTRACTOR TO VERIFY THESE LOCATIONS PRIOR TO CONSTRUCTION AND MAKE EVERY EFFORT TO PROTECT AND/OR RELOCATE THEM AS REQUIRED. THE CONTRACTOR SHALL NOTIFY THE ENGINEER OF DESIGN AS SOON AS POSSIBLE IN THE EVENT A DISCREPANCY IS FOUND.

UTILITY CONTACTS

TELEPHONE SERVICES

AT&T
309 S. WASHINGTON AVE.
SAGINAW, MICHIGAN 48607
(586) 382-9901
mm6798@att.com

PUBLIC UTILITIES
SAGINAW CHARTER TOWNSHIP
DEPT. OF PUBLIC SERVICES
4980 SHATTUCK ROAD
SAGINAW, MI 48603
(989) 791-9870 x 6828
mcomstock@saginawtownship.net

ELECTRIC

CONSUMERS ENERGY
2400 WEISS STREET
SAGINAW, MICHIGAN 48602
(989) 791-6939
virgie.downs@csmenergy.com

ZONING
SAGINAW CHARTER TOWNSHIP
PLANNING & ZONING DEPT.
4980 SHATTUCK ROAD
SAGINAW, MI 48603
(989) 791-9865
bschuth@saginawtownship.net

GAS

CONSUMERS ENERGY
3201 E. COURT STREET
FLINT, MICHIGAN 48506
(810) 247-8227
evan.huizenga@csmenergy.com

CABLE/FIBER
CHARTER SPECTRUM
1480 VALLEY CENTER DRIVE
BAY CITY, MI 48706
(989) 233-9404
mark.kelly@charter.com

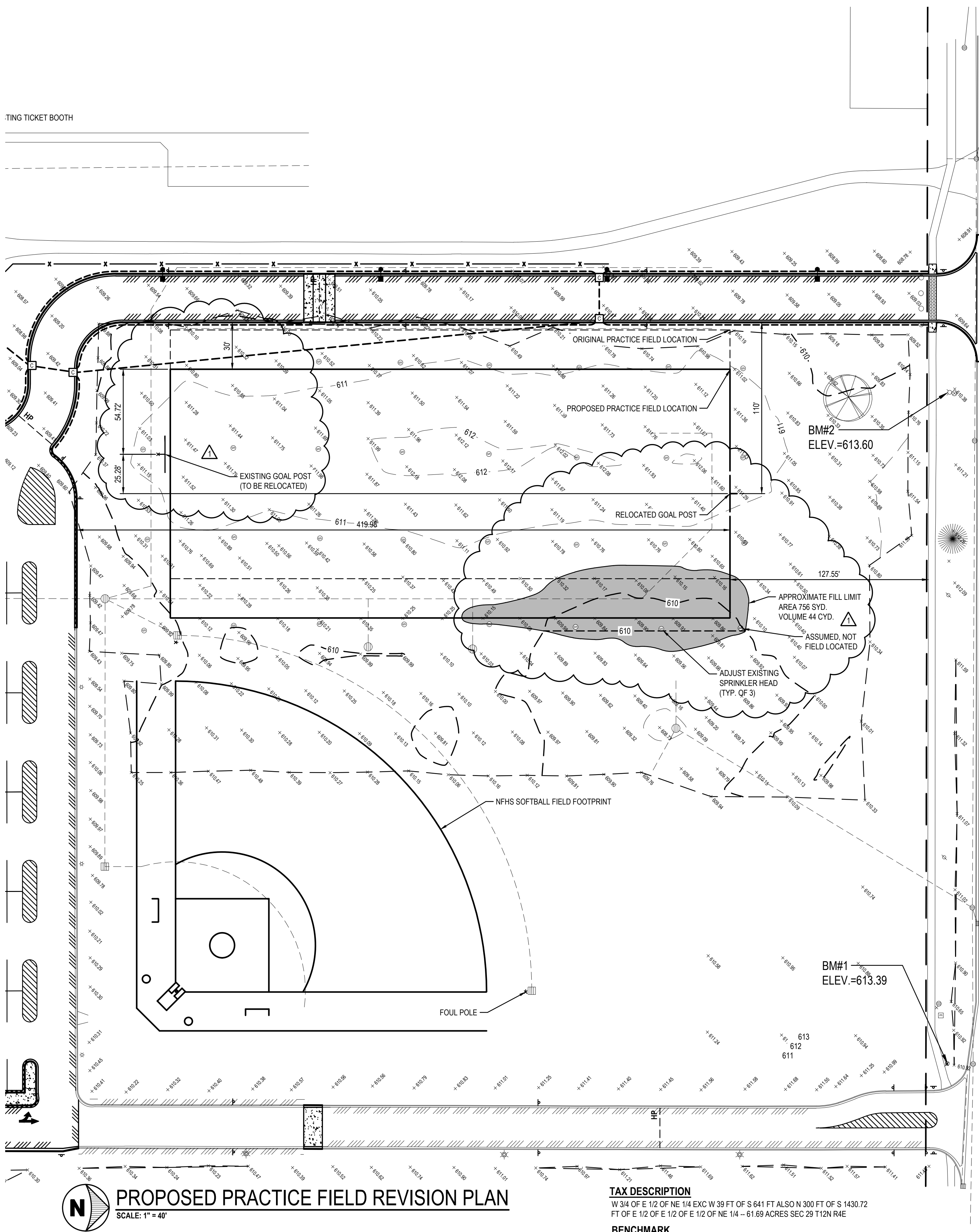

TAX DESCRIPTION

W 3/4 OF E 1/2 OF NE 1/4 EXC W 39 FT OF S 641 FT ALSO N 300 FT OF S 1430.72 FT OF E 1/2 OF E 1/2 OF NE 1/4 - 61.69 ACRES SEC 29 T12N R4E

BENCHMARK

NO.1 - TOP OF NUT ON HYDRANT AT SOUTHWEST CORNER OF SEIDEL STREET AND ENTRANCE DRIVE.
ELEVATION = 613.39 (NAVD 88 DATUM)

NO.2 - TOP OF NUT ON HYDRANT 140 FEET EAST OF AUXILIARY DRIVE EAST OF TRACK FACILITY.
ELEVATION = 613.60 (NAVD DATUM)

NO.3 - ARROW ON HYDRANT AT NORTHWEST CORNER OF SAUK LANE AND SEIDEL ROAD.
ELEVATION = 611.78 (NAVD DATUM)

NO.4 - ARROW ON HYDRANT AT EAST END OF MAIN ENTRANCE BOULEVARD AT NORTH CENTER ROAD.
ELEVATION = 611.55 (NAVD DATUM)

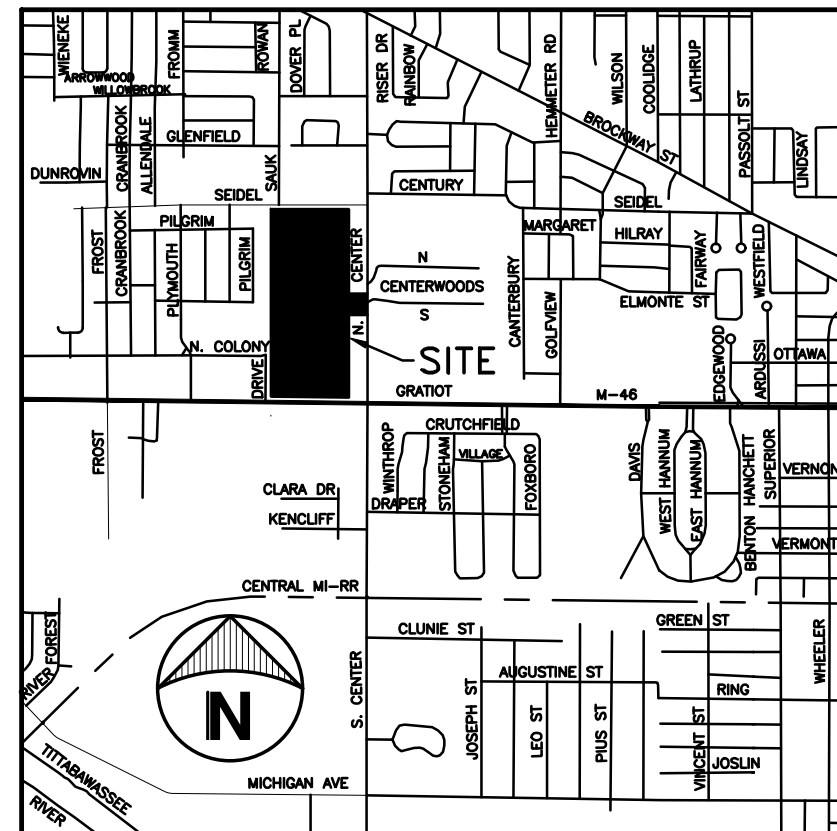

LOCATION MAP

NOT TO SCALE

GRAPHIC SCALE

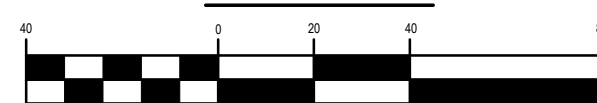

(IN FEET)
1 inch = 40 ft.

LEGEND

- EX. SPOT GRADE
- EX. CONTOUR
- EX. CONTOUR
- EX. CENTERLINE DITCH
- EX. STORM SEWER
- EX. CHAINLINK FENCE
- EX. BUILDINGS
- EX. BITUMINOUS PAVEMENT
- EX. CONCRETE PAVEMENT (C. OR CONC.)
- EX. GRAVEL PAVEMENT
- EX. SIGN WITH POST
- EX. STEEL POST/BOLLARD
- EX. STORM CURB INLET
- EX. STORM CATCH BASIN/MANHOLE
- EX. HYDRANT
- EX. WATER OR GAS VALVE
- EX. SPRINKLER HEAD
- EX. UTILITY POLE
- EX. SEWER CLEANOUT
- EX. LIGHT POLE
- EX. UTILITY RISER
- EX. MAILBOX
- EX. DOWNSPOUT
- EX. FLAG POLE
- EX. ELECTRICAL BOX
- EX. TRANSFORMER
- PROP. SANITARY MANHOLE
- PROP. STORM CATCH BASIN/MANHOLE
- PROP. SIGN
- PROP. STEEL POST/BOLLARD
- PROP. GRADE CONTOUR (MAJR)
- PROP. GRADE CONTOUR (MINR)
- PROP. BITUMINOUS PAVEMENT
- PROP. CONCRETE PAVEMENT
- PROP. SPILL CURB
- PROP. LIGHTPOLE
- LIGHTPOLE (TO BE RELOCATED)

1	ISSUED FOR BIDS	01/16/26
NO.	REVISION	DATE

WTAARCH.COM



WTAARCHITECTS

100 S Jefferson Ave, Suite 601
Saginaw, Michigan 48607
989 752 8107

COPYRIGHT © 2024

WAK WILLIAM A. KIBBE & ASSOCIATES, INC.
ENGINEERS | ARCHITECTS | SURVEYORS
WAK PROJ. NO. 24-0088-0016

PROJECT TITLE
STCS 2026 PROJECTS:
BID PACKAGE NO. 1
WHITE PINE MIDDLE
SCHOOL PRACTICE FIELD
REVISIONS
SAGINAW, MICHIGAN

SHEET TITLE

**PROPOSED PRACTICE FIELD
REVISION PLAN**

PROJECT NUMBER 24.0088.0016	SHEET NUMBER
PROJECT DATE JANUARY 16, 2026	C1.0
CHECKED BY J.WHEELER, P.E.	